

Fitting instructions
Make: Toyota
Corolla Verso; 02-2004->
Type: 4438

Permanently
linked to
quality

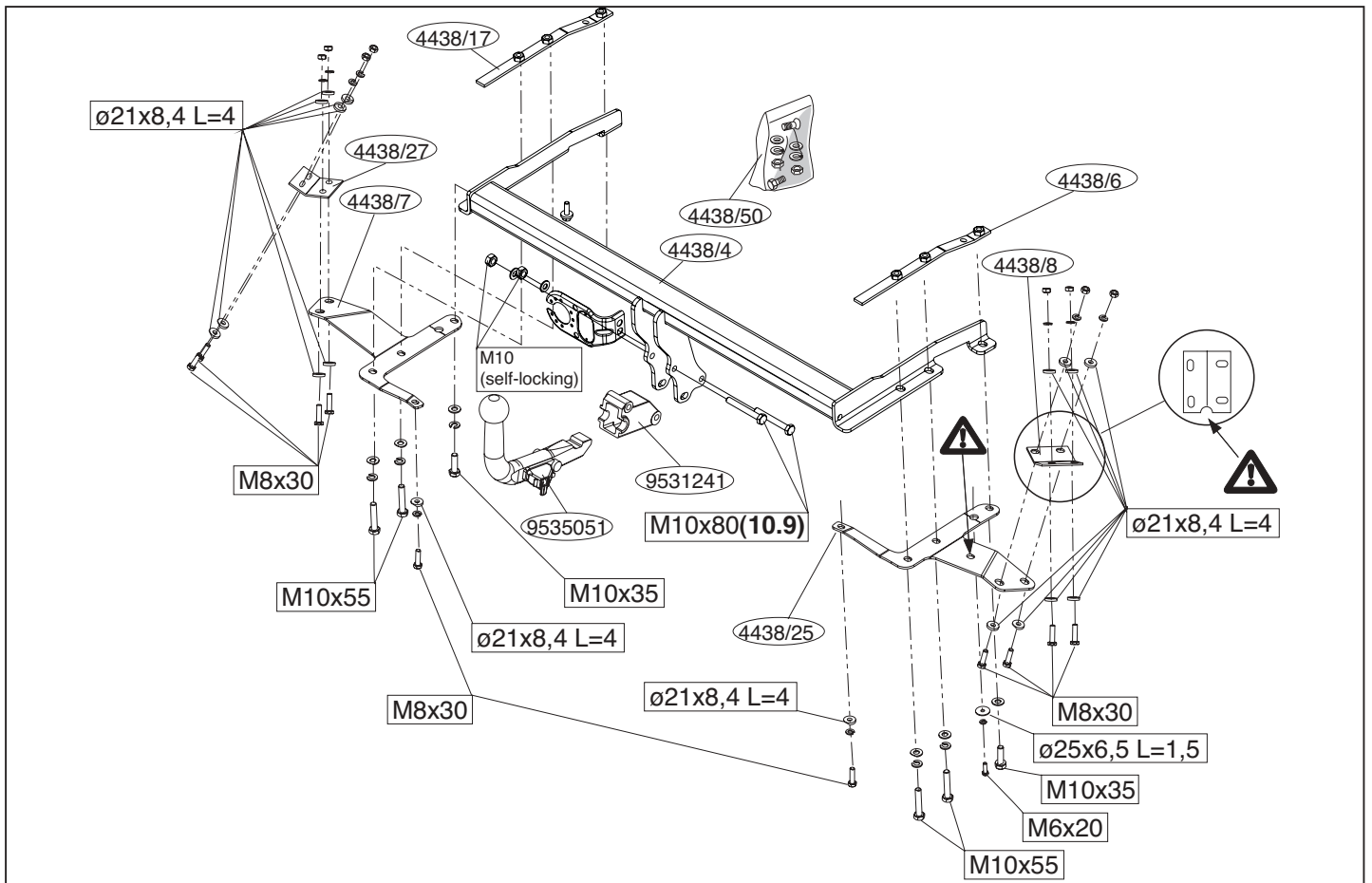

© 443870/27-08-2004/1

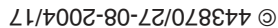
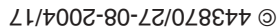

© 443870/27-08-2004/17

© 443870/27-08-2004/17

© 443870/27-08-2004/17

© 443870/27-08-2004/17

© 443870/27-08-2004/17

© 443870/27-08-2004/17

© 443870/27-08-2004/17

© 443870/27-08-2004/17

© 443870/27-08-2004/17

© 443870/27-08-2004/17

© 443870/27-08-2004/17

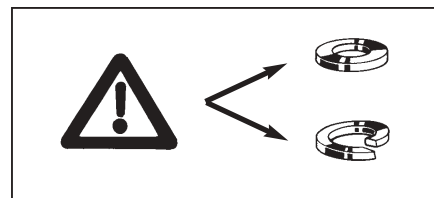
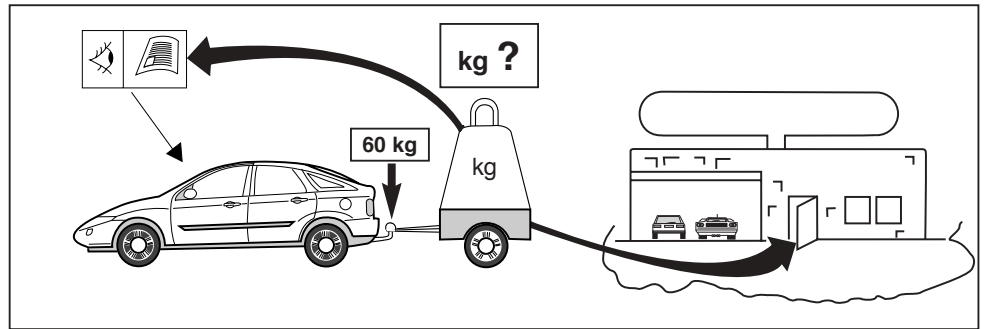
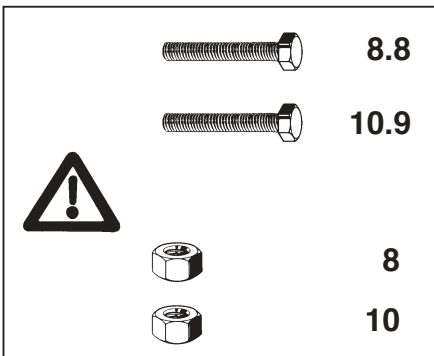
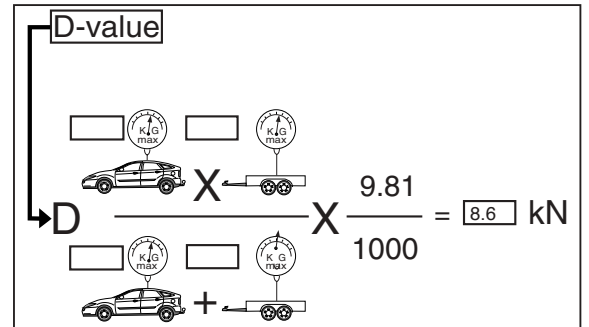
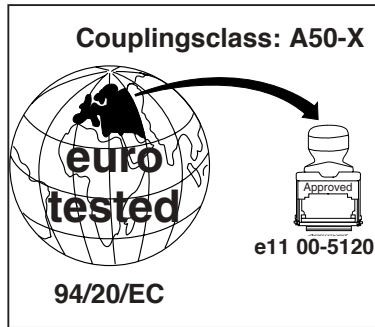
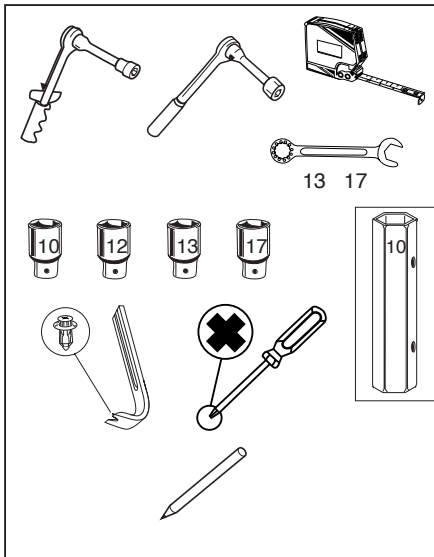

© 443870/27-08-2004/3

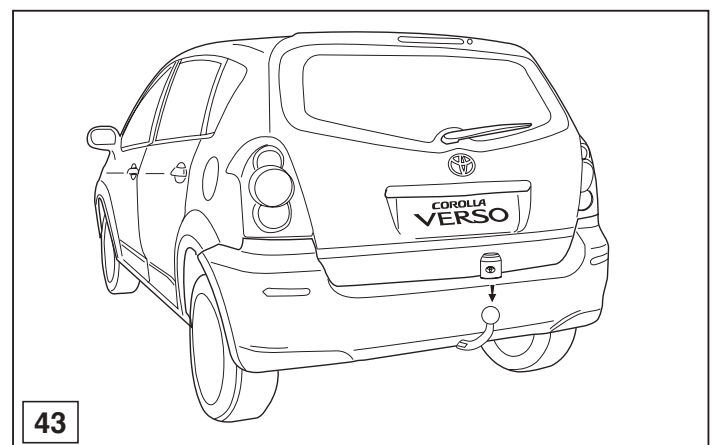
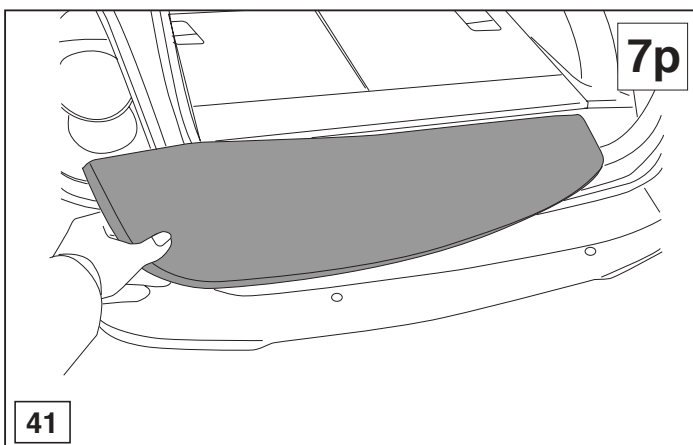
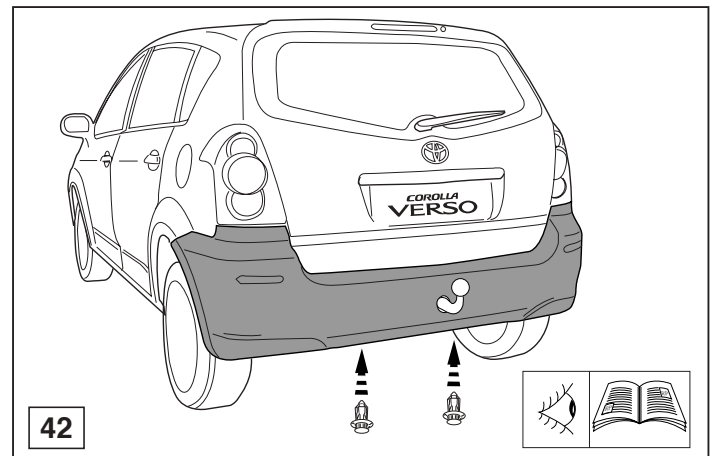
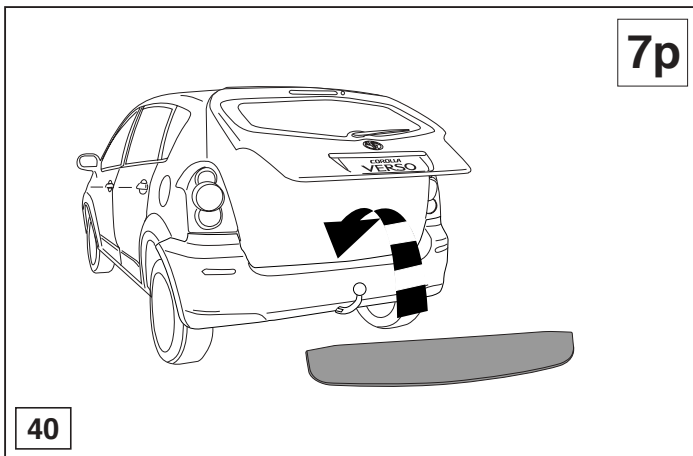

© 443870/27-08-2004/16

0km

1000km

+

0km

M10

19

71 Nm

60 Nm (with self-locking)

M10

17

46 Nm

M8

13

35 Nm

M6

10

9,5 Nm

Torque settings for nuts and bolts (8.8)

Torque settings for nuts and bolts (10.9)

HINWEISE:

* Die für das Fahrzeug zugelassene Anhängelast ist den Fahrzeug Unterlagen zu entnehmen. Bei Änderungen des Fahrzeuggewichtes muß die höchstzulässige Anhängelast gegebenenfalls aus dem D-Wert nachgerechnet werden.
 * Elektrische Anlage gemäß StVZO anbringen.
 * Auskunft hierüber kann Ihr Fachhändler oder der TÜV geben.

36

5p

34

5p

35

5p

38

7p

39

7p

37

5p

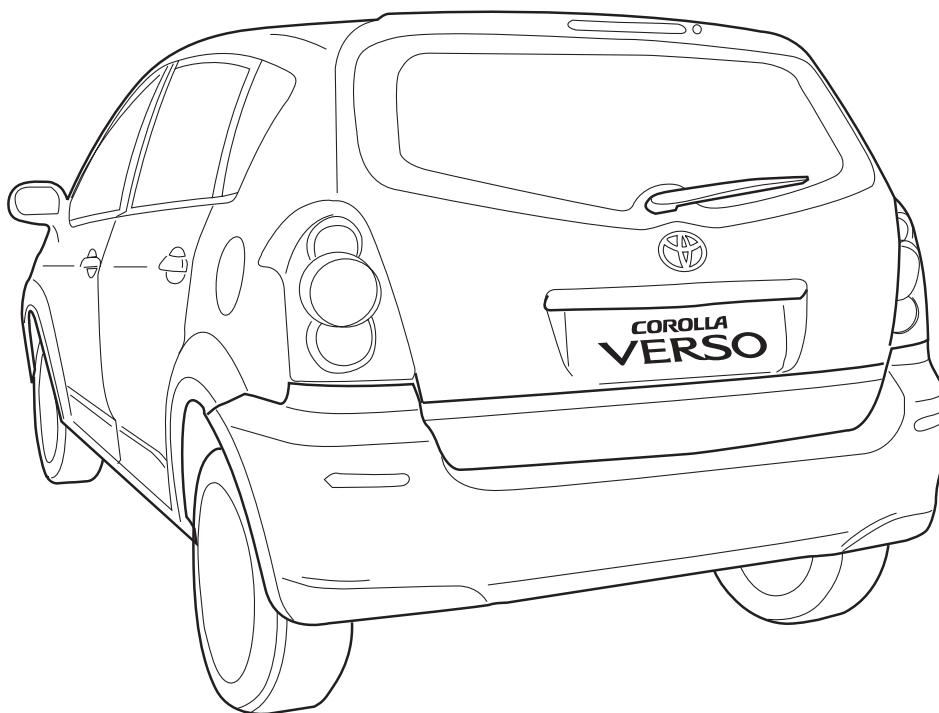

1

© 443870/27-08-2004/5

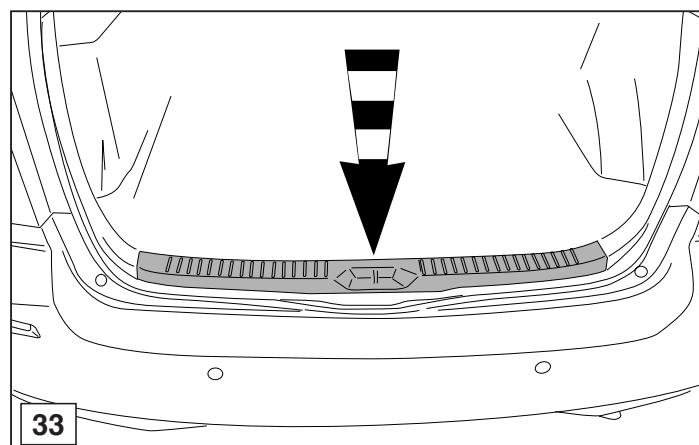
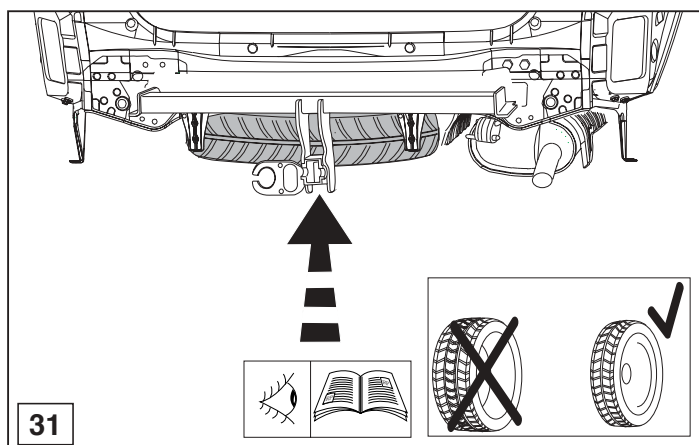
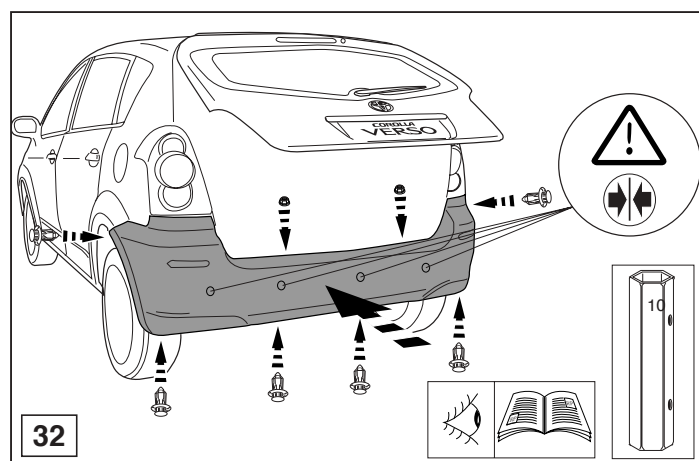
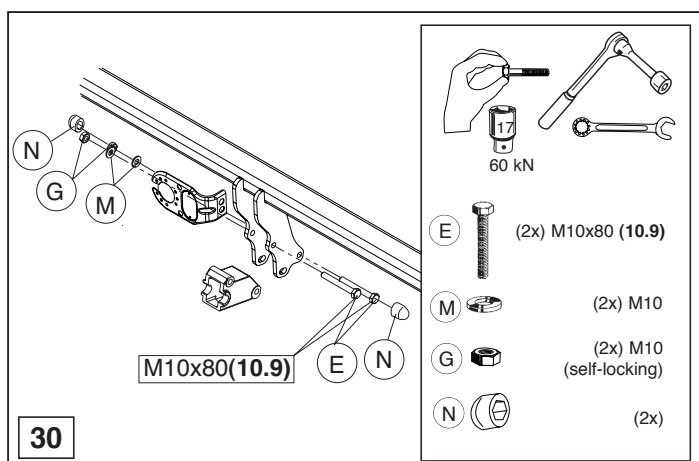

© 443870/27-08-2004/14

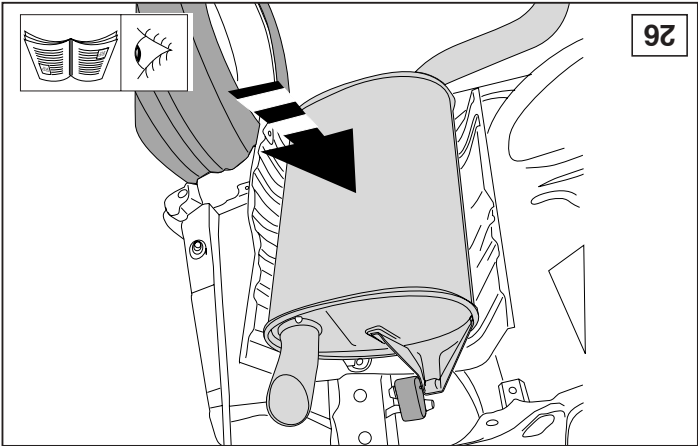
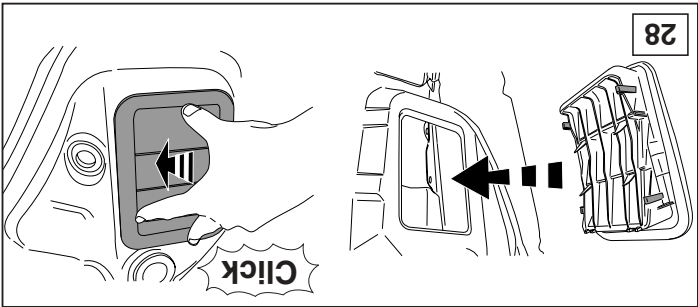
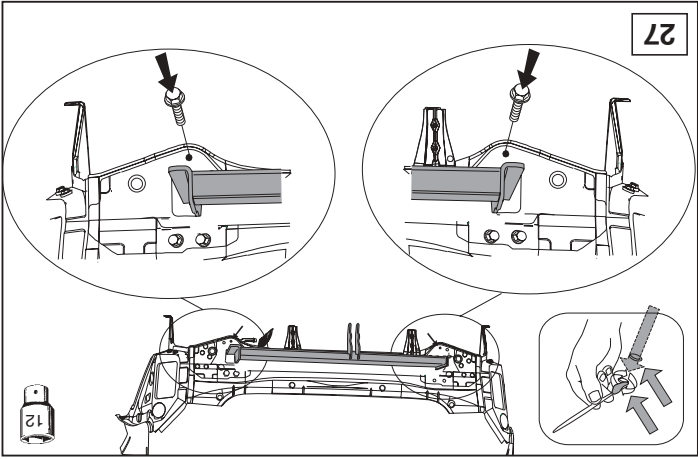
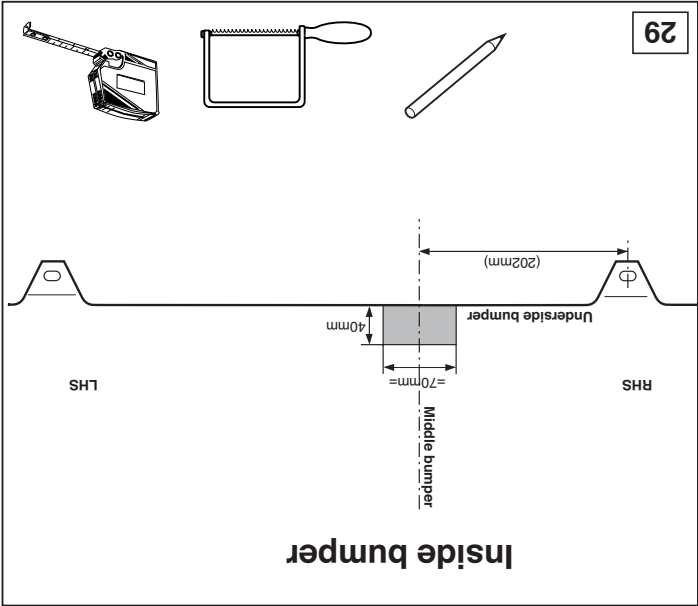
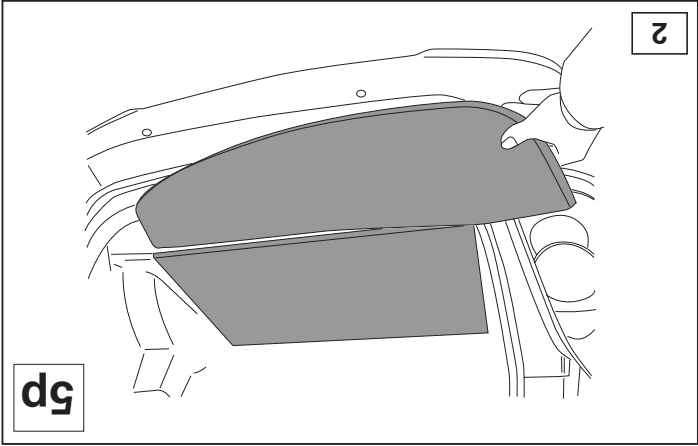
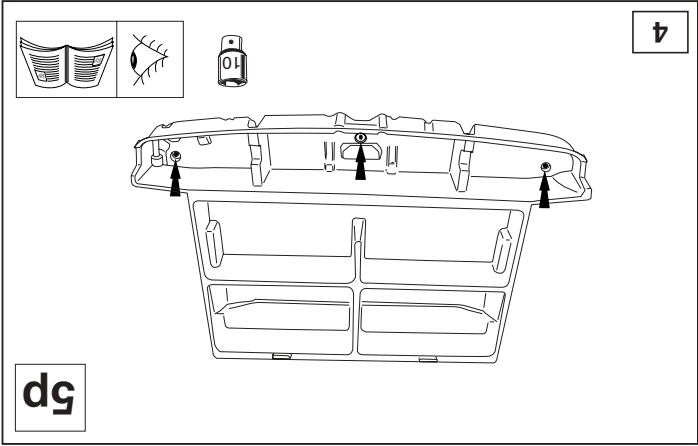
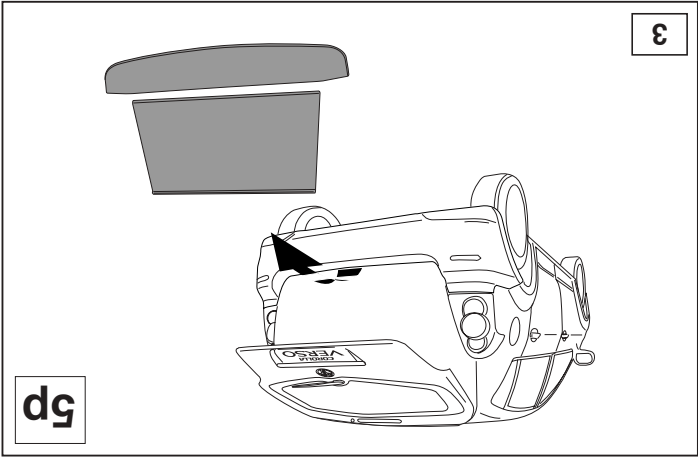
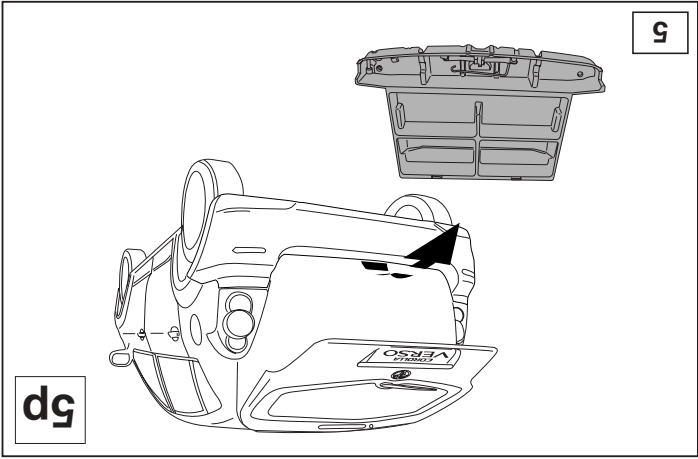

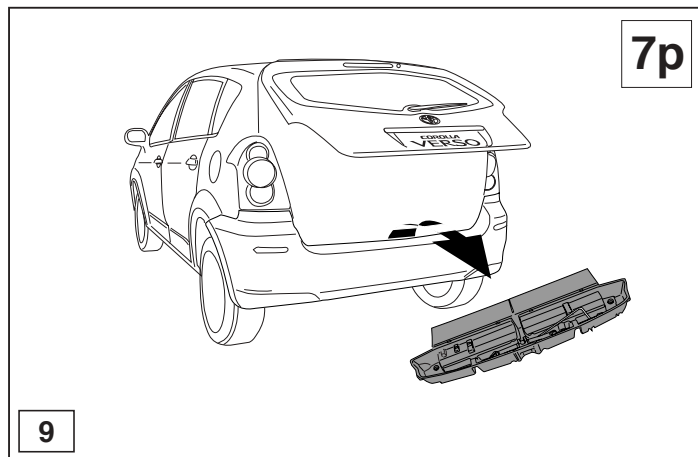
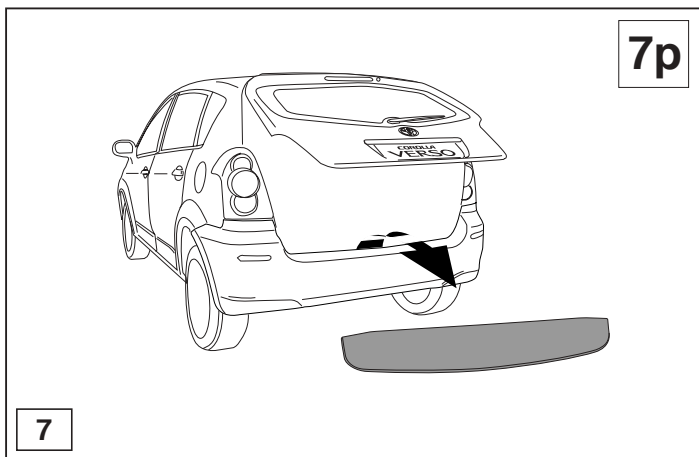
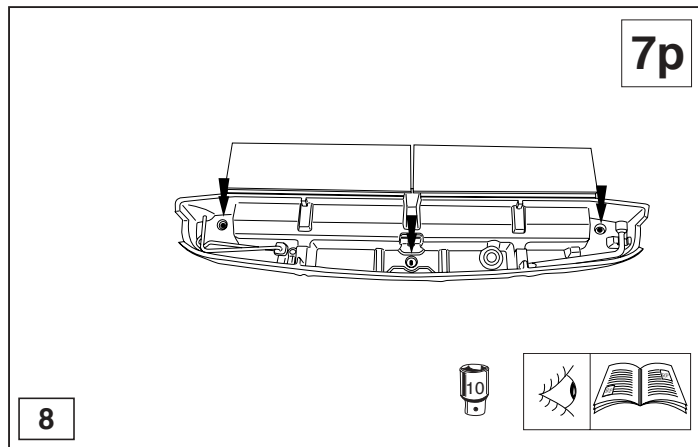
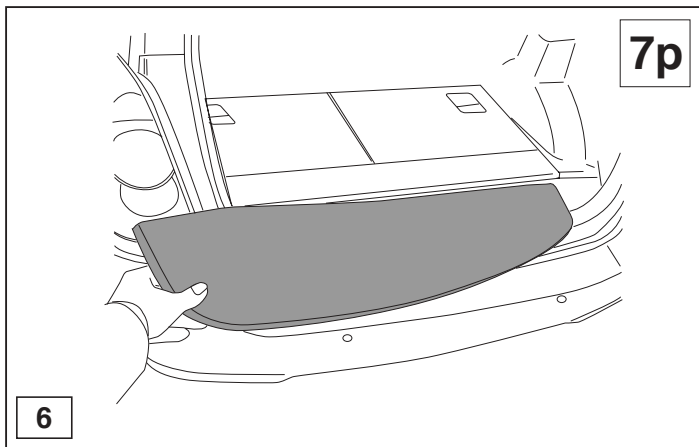

© 443870/27-08-2004/7

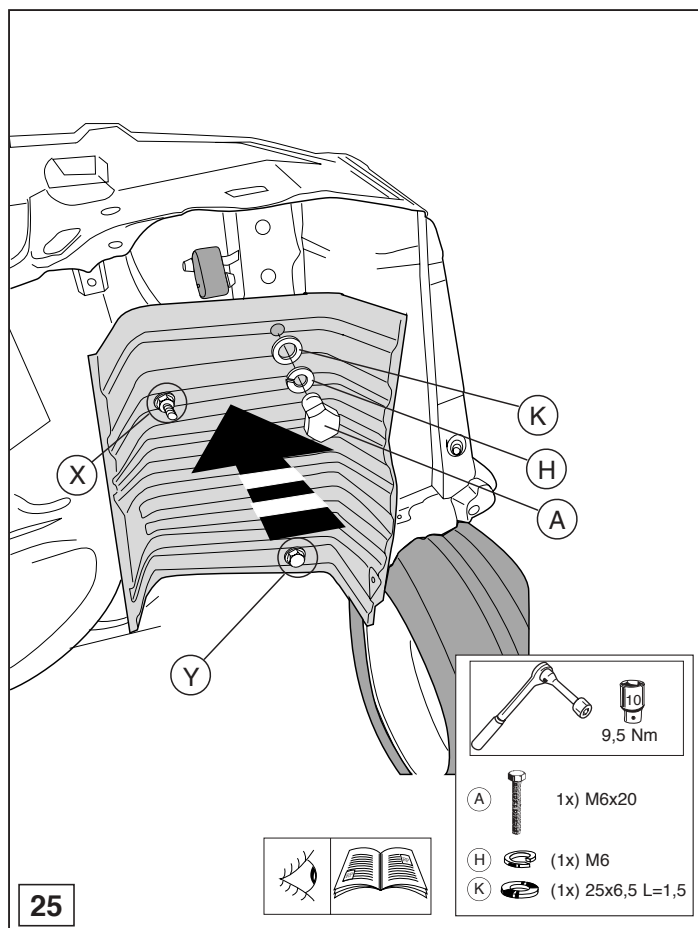
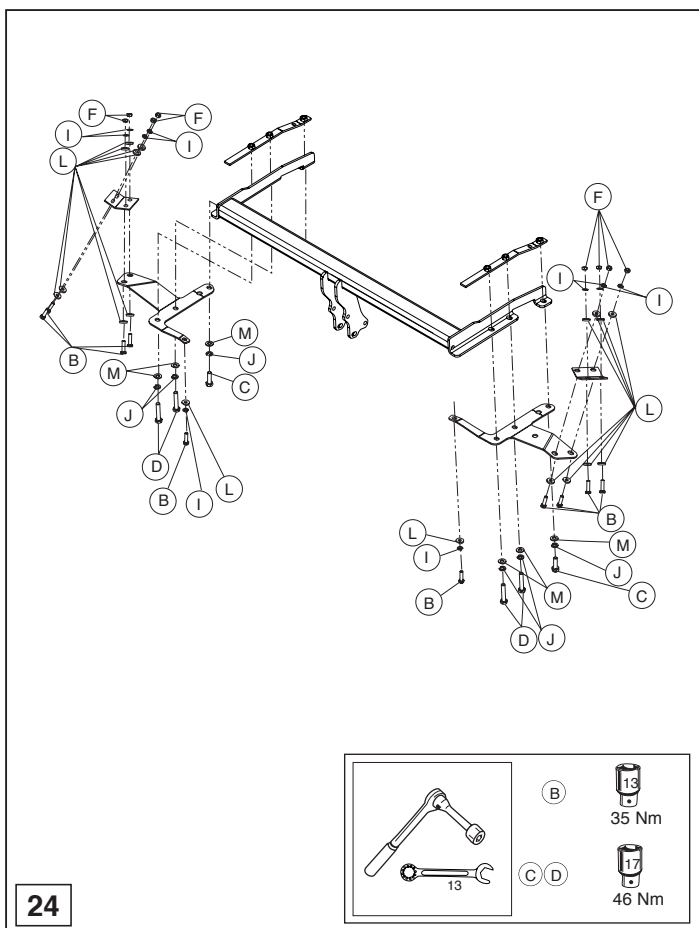

© 443870/27-08-2004/12

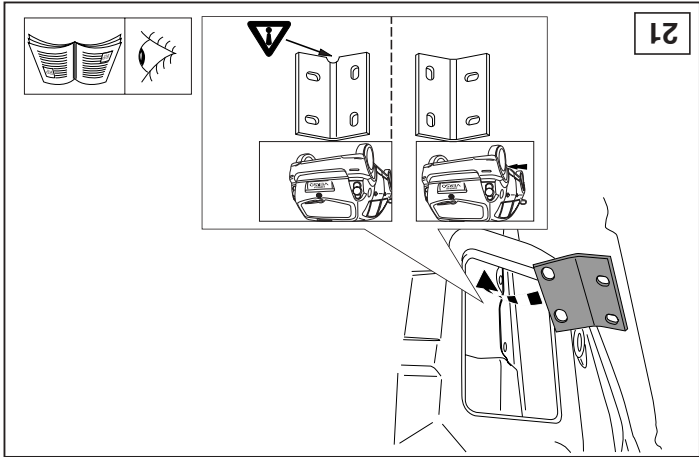
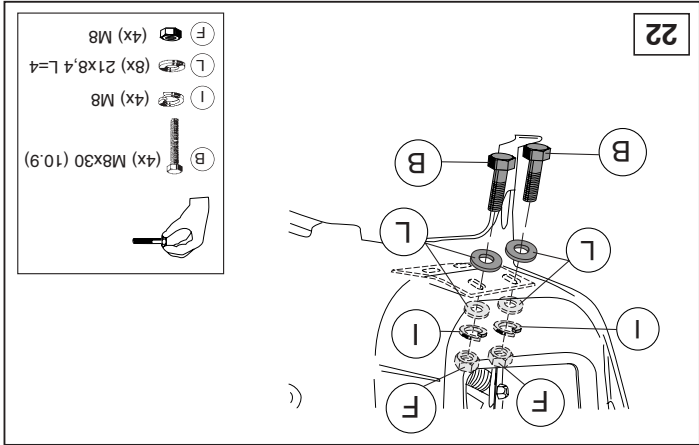
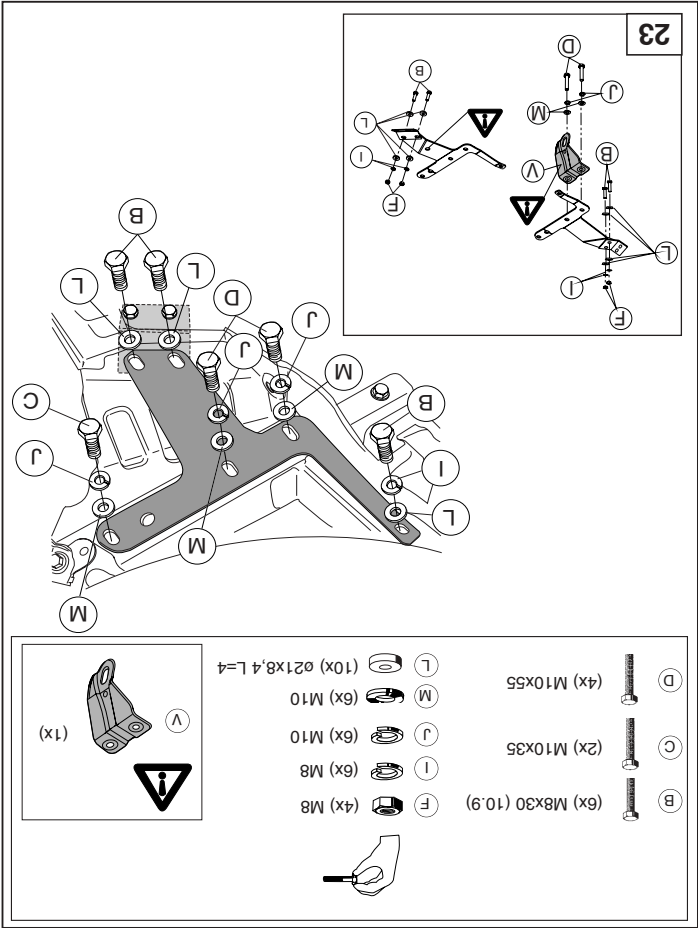
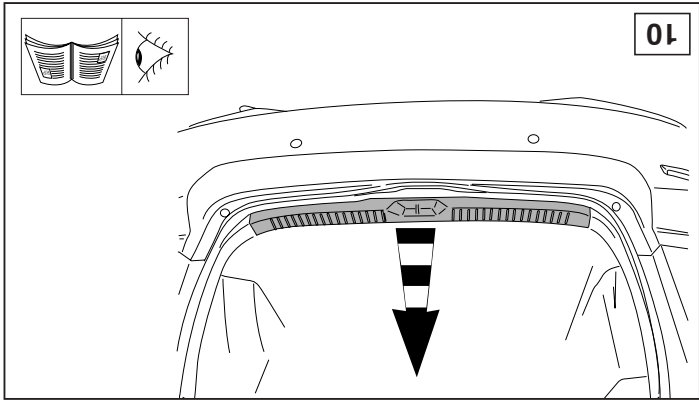
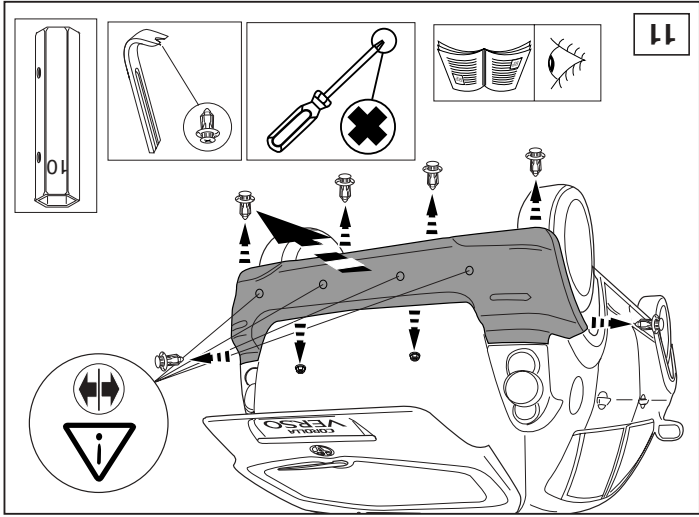
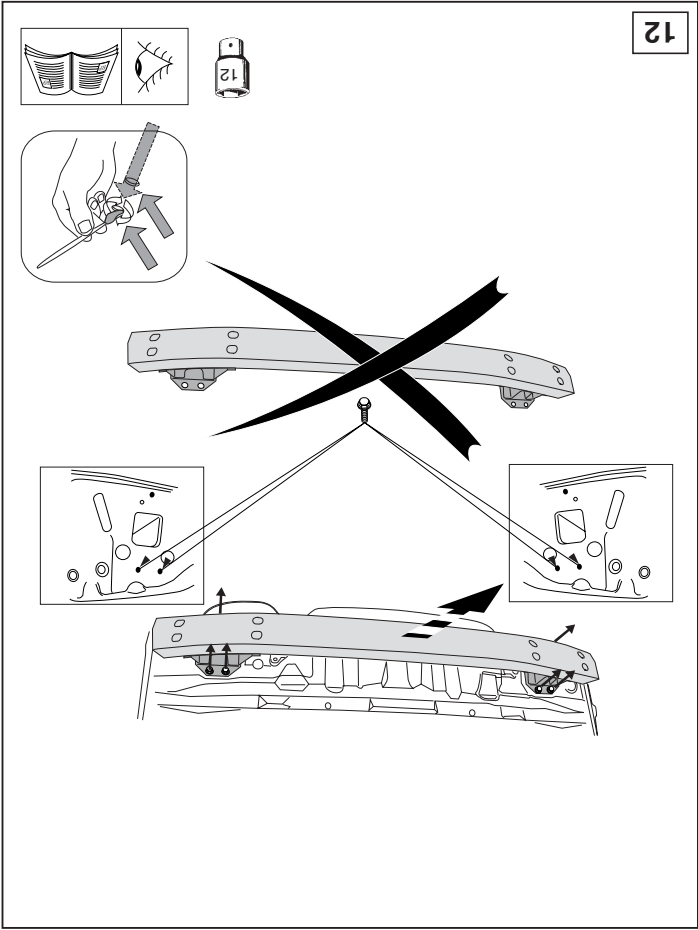

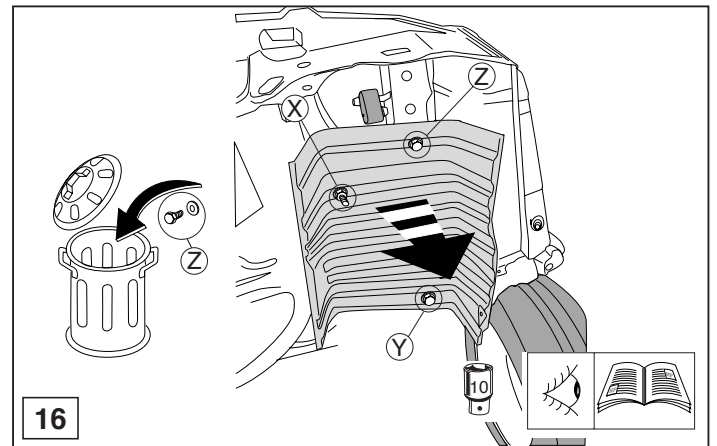
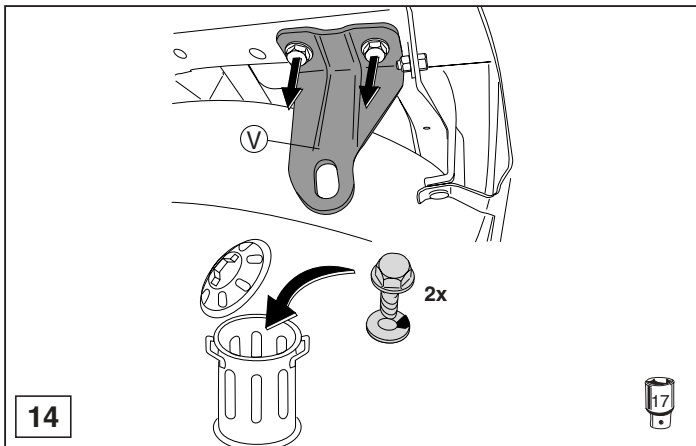
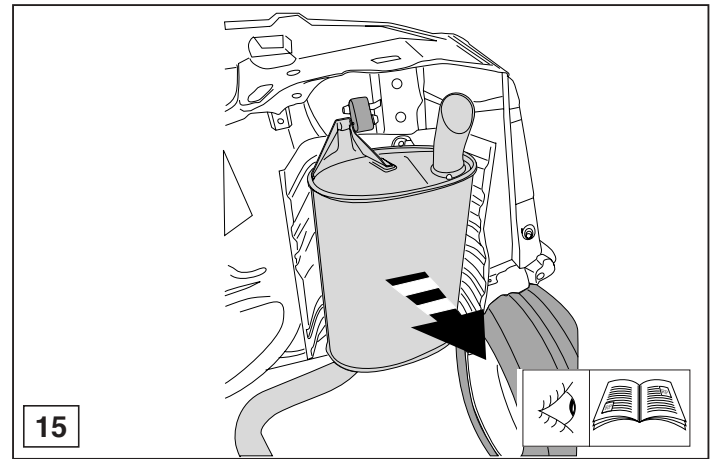
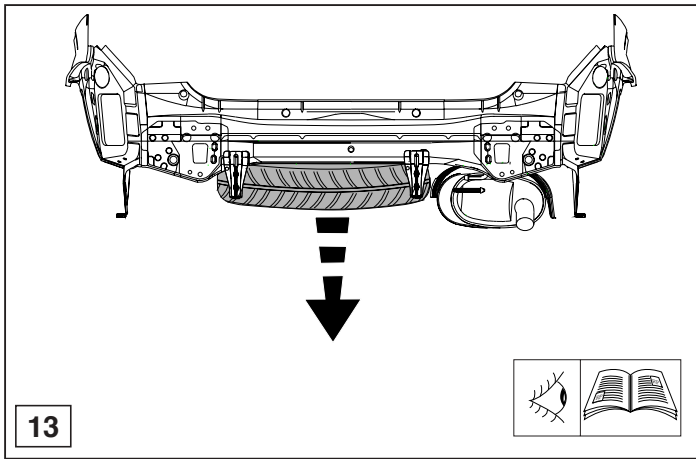

© 443870/27-08-2004/9

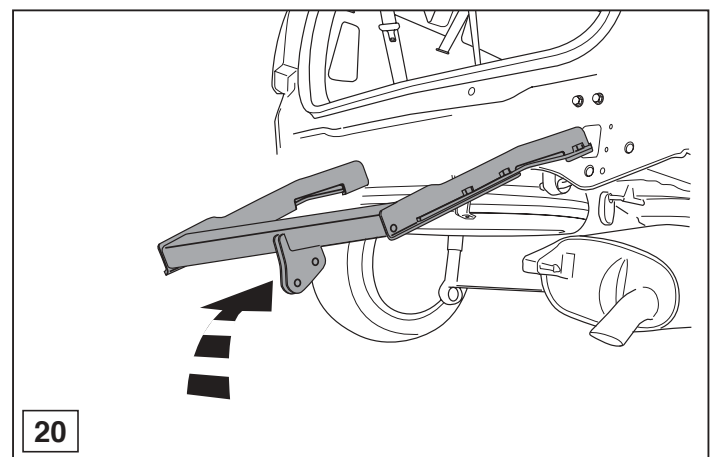
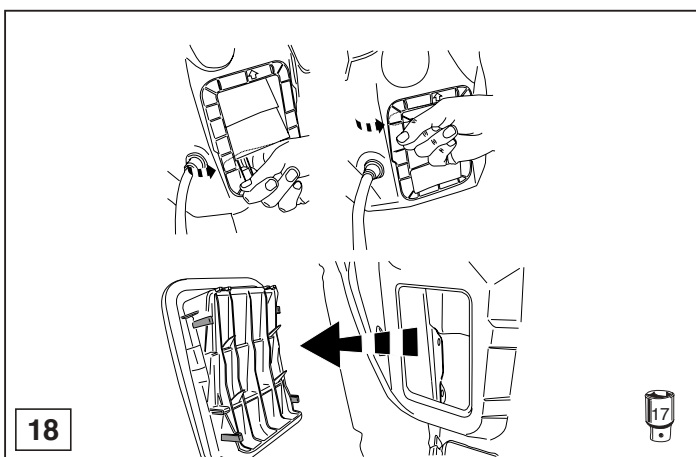
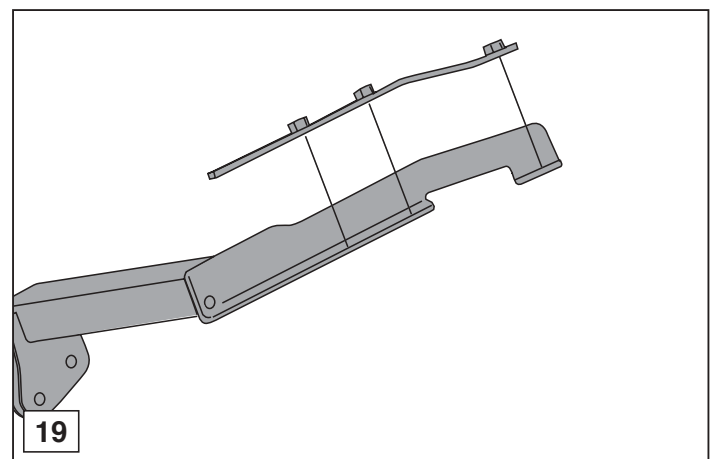
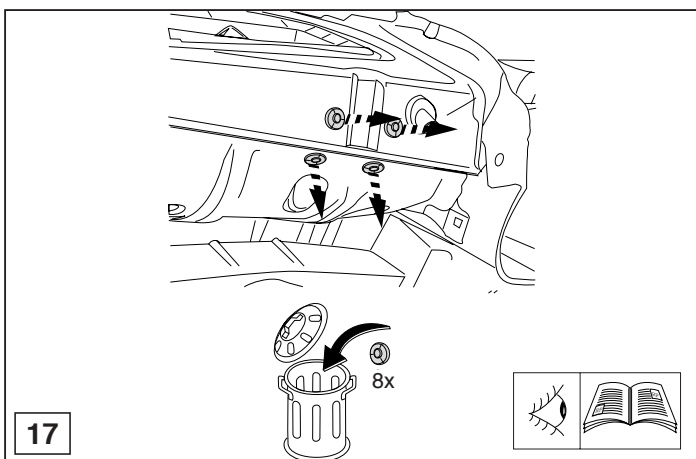

© 443870/27-08-2004/10